

CONSTRUCTION MALAYSIA & SINGAPORE

SEPTEMBER 2018

ISSUE 14 BCI ASIA

# CONSTRUCTION+

Bringing The Building And Design Industry To You

SEPTEMBER 2018 | ISSUE 14 | RM25 | SGD10  
PP19040/06/2016 (034532)  
MCI (P) 114/07/2018

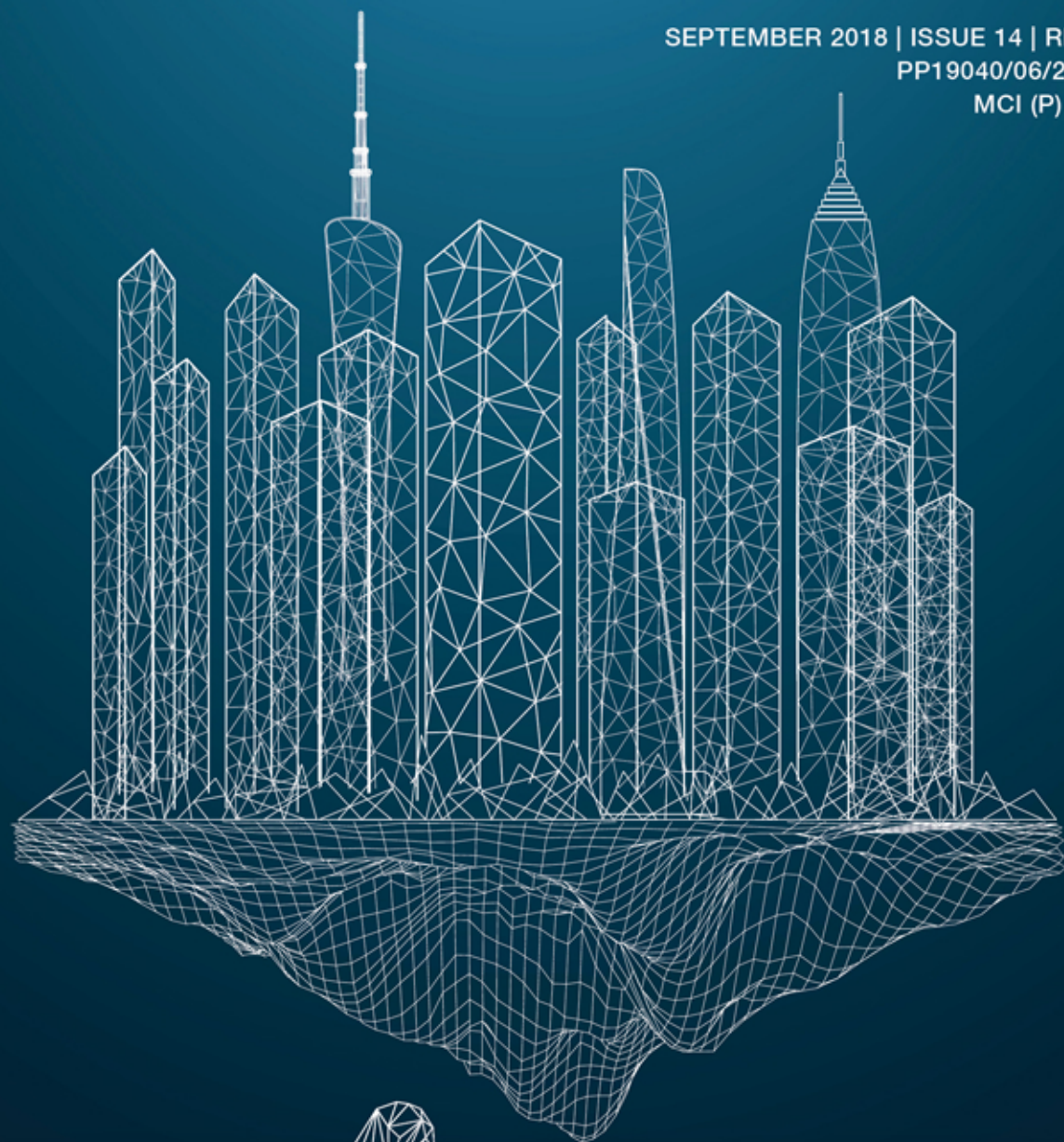

## POSITIONING FOR THE FUTURE

WHY WE NEED REALLY COOL BUILDINGS  
RAISING A GREEN NEXGEN  
SCRAPING SKIES, DIGGING DEEP



05



A play of lights



## INFINITY HOUSE

The site for this private residence is on a hill station in Khandala, India, about 150 kilometres from the city of Mumbai.

The primary requirement in the design brief was for the home to embrace as much of the surrounding views as possible. The complex topography—the plot was irregularly shaped and contoured, with a dense undergrowth—posed the biggest challenge in finding the best angle to orientate the building so that every room could face the view. After surveying the area and a lot of deliberation, the architects made their best guess (48 degrees) and started work, only breathing a sigh of relief when they were standing on the first slab of the house.

Taking advantage of the site contours, the house was designed with the ground floor and a storey above and below. At the centre of the ground floor is the living area, flanked by the kitchen and service areas, changing rooms, jacuzzi and guestroom on one side, and another guestroom and the staircase core on the other. The living area opens up to a deck



Games room



Striking in white



Attached bathroom at the daughter's room

and the pool. The first floor houses the bedrooms, while the lower floor is an entertainment area.

The site was ideal for an infinity swimming pool at the core of the villa, resulting in a juxtaposition of forms that add character to the entire area via an interesting play of light, shadow and volume.

As Khandala experiences heavy rainfall, moisture poses a serious problem to the interiors. As a form of protection, the construction is done in brick and concrete, with 9-inch-thick walls and large overhangs. Furniture is kept to the minimal, and hard materials are used for highlights or feature walls.

The contemporary villa is draped in white, both inside and outside, with white lhasa marble flooring—creating a striking contrast with the lush green gardens. A flat slab construction technique ensured a seamless aesthetic, which further augments the openness and visual connection with the outside.

The living room features a dramatic Brazilian granite wall that

serves as a backdrop to the dining area. Bright-coloured vases and a yellow sofa break the monotony.

On the first floor, the master bedroom is cantilevered partially over the swimming pool below for the best views and to provide shade to the outdoor sitting beneath. The volume and geometry enables the dynamism of the overall design.

The son's room is a stark minimalistic combination of a patterned concrete wall, wooden floor and a large bed with a Satvario marble backrest. High windows on two sides of the bedroom open out to a huge deck, surrounded by lush green trees.

The daughter's room opens out onto a huge balcony with a scenic corner view. A painting forms part of the ceiling design, while the rest of the bedroom is simple with a leather platform bed.

The games room has a different palette altogether, with cement walls and floor tiles and a stark red wall. 



Infinity pool

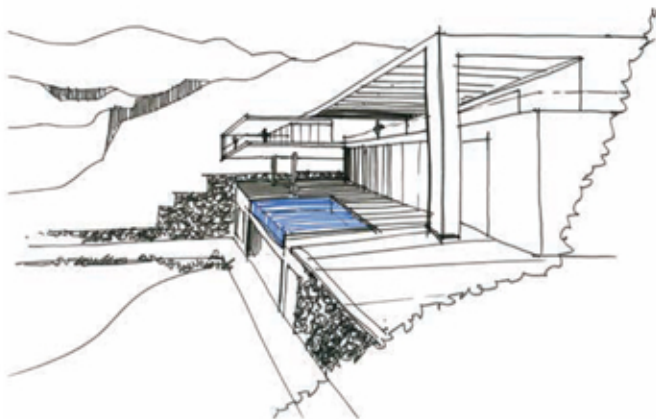

Sketch

#### PROJECT DATA

**Project Name**  
Infinity House

**Location**  
Khandala, Maharashtra, India

**Completion Date**  
May 2017

**Site Area**  
1,208 square metres

**Gross Floor Area**  
1,300 square metres

**Building Height**  
2 storeys with basement

**Architecture Firm**  
GA design

**Principal Architect**  
Rajan Goregaoker

**Interior Design Firm**  
GA design

**Principal Designer**  
Rajan Goregaoker

**Civil & Structural Engineer**  
MR Enterprises and Integrated Building Services

**Mechanical & Electrical Engineer**

Neha Electricals

**Lighting Consultant**

Neha Electricals

**Main Contractor**

MR Enterprises

**Images**

Prashant Bhat